

Components Included

- | | | |
|----|------------------------|---|
| 1. | RTR Hood Vent | 1 |
| 2. | Installation Scan Card | 1 |
| 3. | Hardware Pack | 1 |

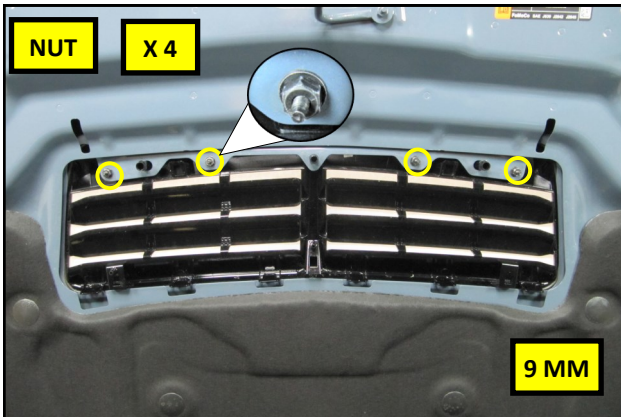

1. With the hood raised, use a 9 mm socket to remove the 4 nuts securing the hood vent to the hood.

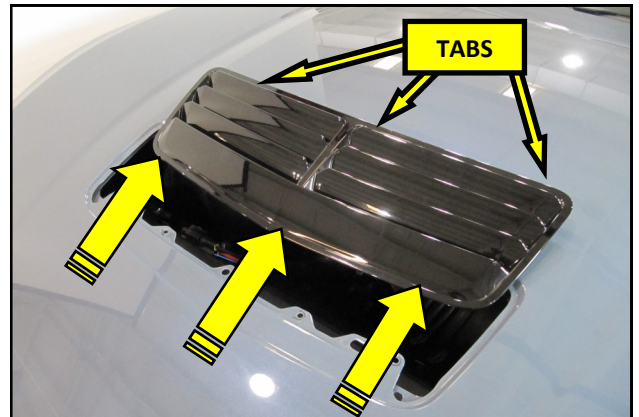

2. With the hood lowered, lift the vent upward and remove it from the vehicle. **NOTE:** The hood vent is secured at the rear by six tension tabs. These tabs will require some additional force to overcome.

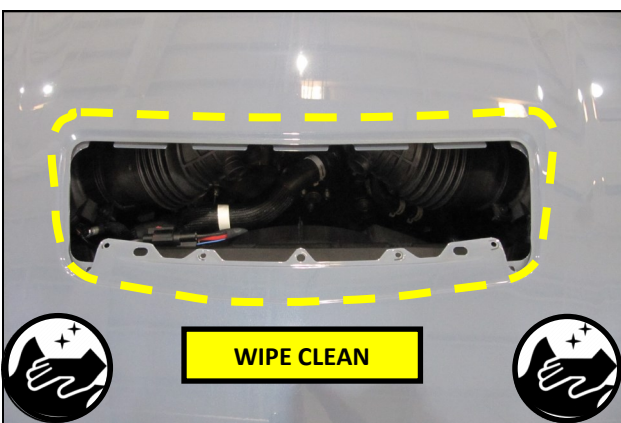

3. Using a mild solution of soap and water, carefully wipe away any and all debris that may have accumulated under the OEM vent.

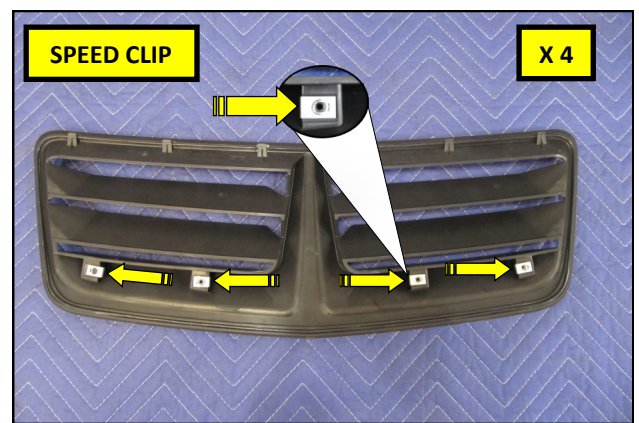

4. Place the RTR Hood vent, face down onto a padded work surface. Slide the supplied Speed Clips onto the RTR Hood Vent as shown.

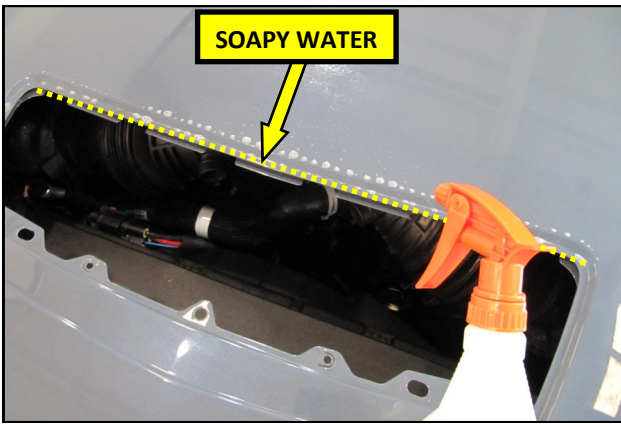

5. Spray a generous amount of soapy water on to the rear of the hood opening to be used as an install lubricant.

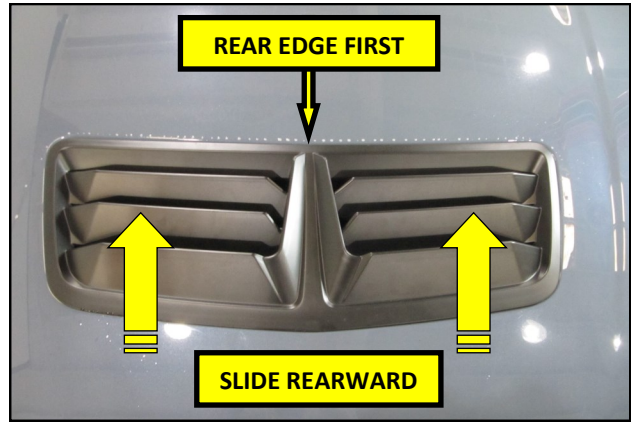

6. Slide the RTR Hood Vent, rear edge first, into the hood opening and lower the front down into the proper position.

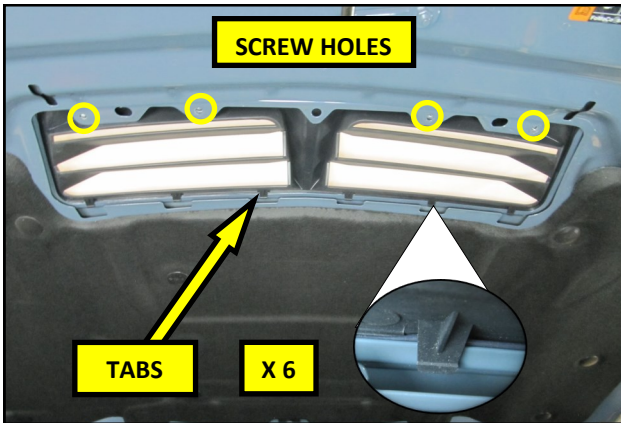

7. Verify that the Vent tabs are fully seated onto the hood and that the Speed Clips are aligned with the holes in the hood.

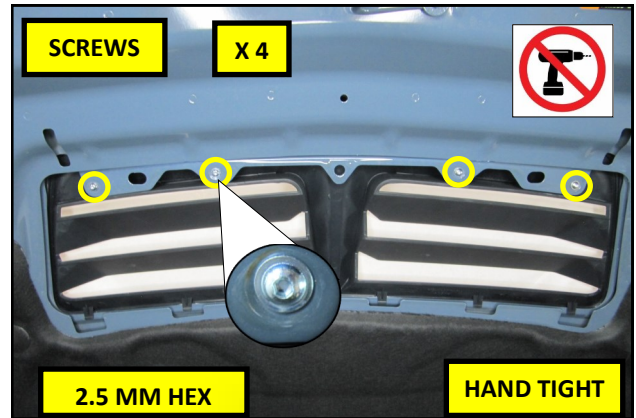

8. Using a 2.5 MM Hex driver, secure the Vent to the hood using the supplied M4 Screws. Tighten the screws by hand to avoid over tightening.

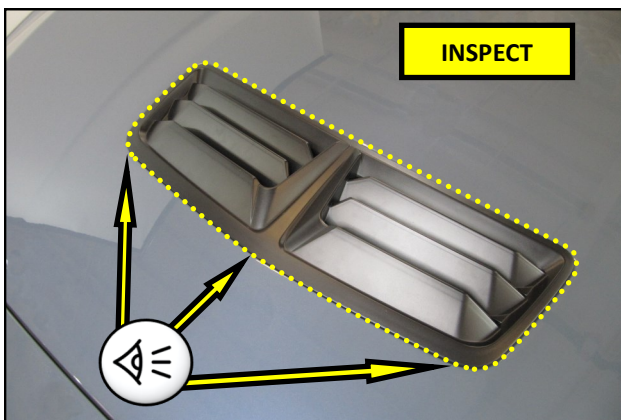

9. Inspect the installed RTR Hood Vent. When properly installed, the Hood Vent is to be evenly seated into the recess of the hood stamping. Adjust the metal hood tabs if necessary.

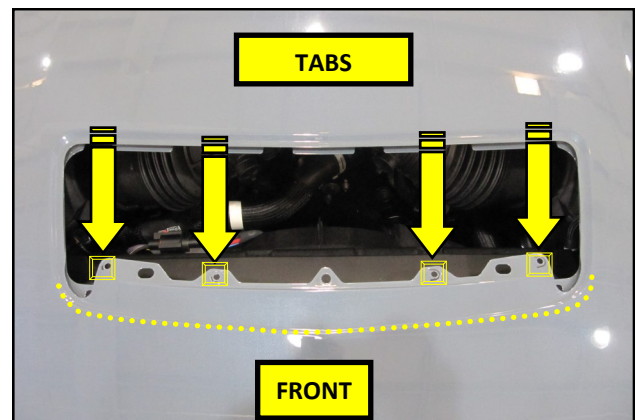

10. **FINAL ADJUSTMENT**– If an adjustment is needed, remove the RTR Hood Vent from the vehicle and set it aside. Reposition the sheet metal tabs as needed to achieve a proper fit inside of the hood. The Install is now complete.