



**INSTALLATION
INSTRUCTIONS**



Part # 11169102



Rear Sway Bar

1967-1969 GM F-Body





**Please Read And Understand All Instructions
And Warnings Prior To The Installation Of
This Product.**

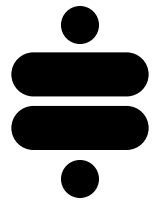

THANK YOU

Congratulations on your new Ridetech product! It's an honor that you've selected the Ridetech brand to upgrade your ride. Our products are developed around quality and performance without compromise. We're confident you'll have many years (and miles) of pure driving enjoyment.
Thank you for choosing Ridetech!

Road Map

Safety & Recommended Tools	3
Exploded View & Parts Listing	4
Bar Assembly/Mounting	5
Bar Mounting	6
Axle Tab Installation	7
Finishing Touches	8



**THIS SWAY BAR IS DESIGNED TO ONLY BE COMPATIBLE
WITH THE RIDETECH 67-69 CAMARO REAR 4-LINK KIT.**



**The rear 4-link kit must be installed prior to installing
this sway bar.**

**The bushings in this kit contain an anti-friction lining.
No lubrication is required.**



SAFETY FIRST



Always use jack stands (if not using a lift). Never rely solely on a hydraulic jack to support the vehicle.

Always raise the vehicle on a clean and level surface. Use wheel chocks when necessary.

Be sure to wear proper Personal Protective Equipment (PPE) when welding.

Always wear eye protection (Z87.1) when operating power tools.

RECOMMENDED TOOLS

Jack Stands or Lift

Tape Measure

Welder

Torque Wrench

Metric Socket/Wrench Set

SAE Socket/Wrench Set

5/16" Allen Hex Socket

EXPLODED VIEWS AND PARTS LISTING

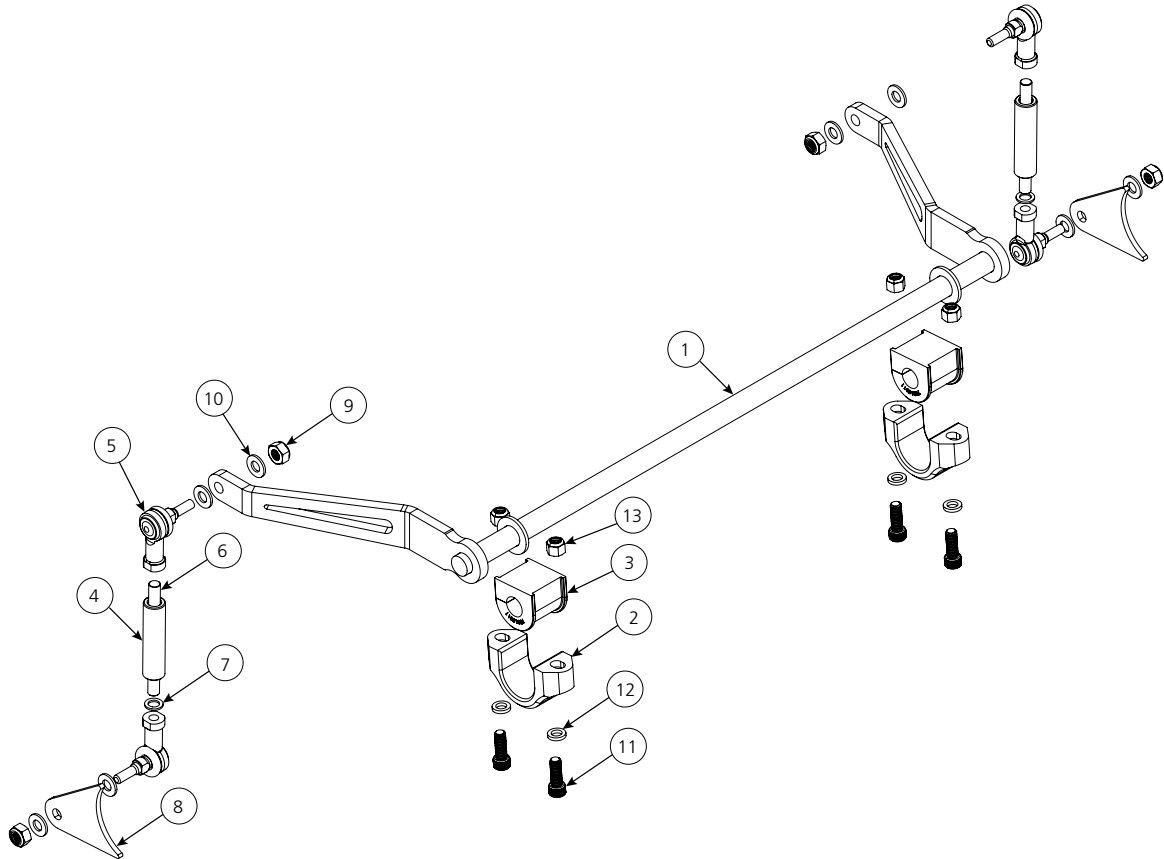

Item #	Part #	Description	QTY
1	90003635	67-69 F-BODY REAR SWAY BAR	1
2	90001344	BILLET SWAY BAR MOUNT, 1.55"	2
3	70015011	.75 ID LINED SWAY BAR BUSHING	2
4	90000114	Posilink Spacer	2
5	90003842	CCTY End Link 10mm 90 Degree	4
6	99115003	M10-1.5 x 4.5"(115 mm) Stud	2
7	90002275	Washer, Copper Crush	2
8	90001845	SWAY BAR TAB; WELD ON	2

HARDWARE KIT: 99010273			
Item #	Part #	Description	Qty
POSILINK			
9	99112002	M10-1.5 NYLOK NUT	4
10	99373003	3/8 SAE FLAT WASHER	8
SWAY BAR TO CRADLE			
11	99371034	3/8-16 x 1 SOC CAP BOLT	4
12	99373020	3/8 SAE FLAT WASHER	4
13	99372001	3/8-16 GR 8 NYLON INSERT	4
SWAY BAR TO CRADLE (Old Design Only)			
14	99371079	3/8-16 x 1/2 SHCS	2
15	99373005	3/8 SPLIT LOCKWASHER ZINC	4

Bar Assembly/Mounting

1. Raise the vehicle to a safe and comfortable working height.

Tip: Removing the rear Coilovers or ShockWaves may help to simplify this installation.

2. Spread open each bushing at the split and install onto the bar. Position the bushing just to the inside of the stop ring (Figure 1).

3. Slide a billet strap over each bushing as shown in Figure 2.

NOTE: Before mounting the bar to the cradle, determine if you have the new or old style cradle. If you have the old-style cradle, the holes in the sway bar mounts will be threaded. On the new cradle design, the holes will not be threaded.

4. With the bushing/straps installed on the bar, position the bar onto the mounting flanges of the rear cradle (Figure 3).



Figure 1



Figure 2



Figure 3

Bar Mounting

5. Bolt the sway bar to the cradle with the following hardware from the 99010273 hardware kit:

Revised Cradle Design

- (4) 3/8"-16 x 1" socket-head bolts
- (4) 3/8" flat washers,
- (4) 3/8"-16 nylok nuts

Torque to **30 ft-lbs.**

Old Cradle Design

Front Mounting Holes:

- (2) 3/8"-16 x 1" socket-head bolts
- (2) 3/8" split lock washers
- (2) 3/8" flat washers

Rear Mounting Holes:

- (2) 3/8"-16 x 1/2" socket-head bolts
- (2) 3/8" split lock washers
- (2) 3/8" flat washers

Torque to **16 ft-lbs.**

6. Insert the pre-assembled end link in the hole of the sway bar arm. The threads should be pointing inboard (Figure 6).

Install a 3/8" flat washer followed by an M10-1.5 nylok nut. Torque to **37 ft-lbs.**



Figure 4



Figure 5



Figure 6

Axle Tab Installation

7. Before attaching the axle tabs, you'll need to ensure the axle is at ride height.

One helpful trick to help maintain ride height while setting up the rear MuscleBar is to put a spacer between the axle and the outside of the frame as shown in Figure 7. The spacer should be 8 1/2" tall, giving the shock an eye-to-eye measurement of approximately 14 1/2".

8. Attach an axle tab to the lower end of the PosiLink. Use a 3/8" flat washer on each side of the tab. Install a M10-1.5 nylok nut and tighten enough to hold it in place.

With the axle at ride height and the arms of the MuscleBar level, swing the axle tab up against the axle tube (Figure 8).

Remove any paint or rust in the area to be welded. When positioning the tab, make sure it is vertical and square with the axle.

9. With the tabs in place, tack weld them to the axle tube (Figure 9). After the tabs have been tack welded on both sides, disconnect the PosiLinks from the axle tabs.

Let the axle drop down for better access to the tabs. Lay 1" welds on the inside and outside of the tabs. Skip around from one side to the other to avoid overheating the axle tube.



Figure 7



Figure 8



Figure 9

Finishing Touches

10. Once the tabs have cooled down, paint or touch up the tabs and surrounding area. Reconnect the PosiLinks (Figure 10 & 11).

Torque the nuts to **37 ft-lbs.**

11. If you removed your Coilovers or ShockWaves, you may reinstall them now.

Torque the upper shock bolts to **55 ft-lbs.**

Torque the lower shock nuts to **40 ft-lbs.**



Figure 10



Figure 11