

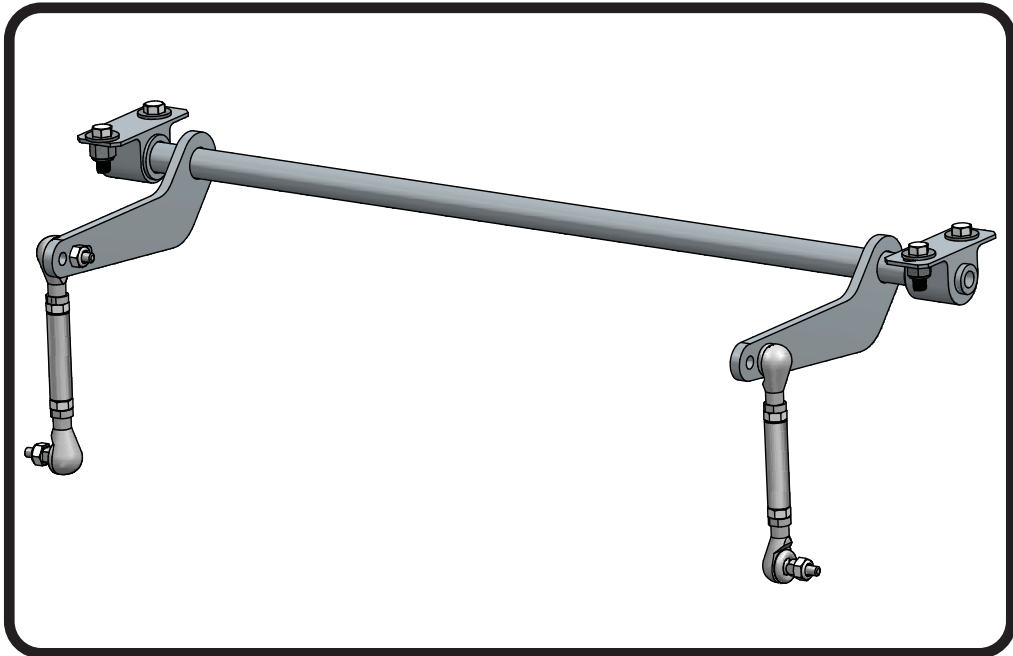

Part # 11339102 - 1963-1972 C10 Rear MuscleBar

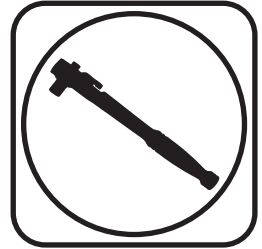

Recommended Tools



1963-1972 C-10 Rear MuscleBar Installation Instructions

Table of contents	
Page 2.....	Included Components and Hardware List
Page 3.....	Getting Started
Page 4.....	MuscleBar Installation



Major ComponentsIn the box

Item #	Part #	Description	QTY
1	90002433	C-10 Rear MuscleBar Assembly	1
2	90001343	Bushing Frame Bracket	2
3	70015012	Lined Sway Bar Bushing	2
4	90000926	10mm 90 degree elbow (Preassembled Posilink)	4
5	90000114	Posilink Spacer (Preassembled Posilink)	2
	99115003	M10-1.5 115mm stud (Preassembled Posilink)	2

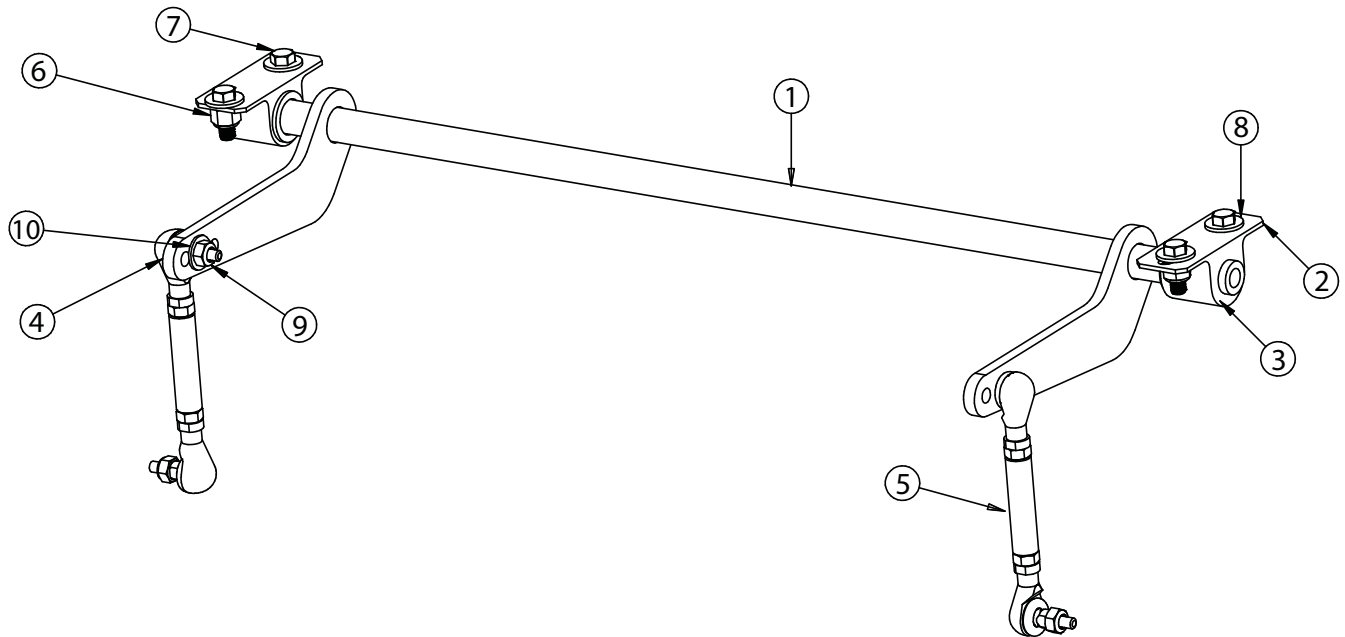

Hardware ListIn the box Hardware Kit# 99010059

Item #	QTY	Part Number	Description	Location
6	4	99432001	7/16" Nylok Nut	Swaybar bushing to Frame
7	4	99431002	7/16"x 1 1/4" Hex Bolt	Swaybar bushing to Frame
8	8	99433002	7/16" SAE Flatwasher	Swaybar bushing to Frame
9	4	99112002	M10-1.5 Nylok Nut	Posilink to Swaybar and StrongArm
10	8	99373003	3/8" SAE Flatwasher	Posilink to Swaybar and StrongArm



Getting Started.....

Congratulations on your purchase of the Ridetech Rear MuscleBar. This kit has been designed to give your truck excellent handling along with a lifetime of enjoyment. Some of the key features of this MuscleBar: Posilinks - The Posilink makes the reaction of the swaybar instantaneous, tuneability - this Musclebar has 3 positions to aid in the tuning of the handling of your truck.

Note: This MuscleBar is designed to be used with the Ridetech Shockwave/Collover System.

Note: It is necessary to remove the bed to install this MuscleBar. The best time to install the swaybar, is while installing the rear StrongArm system.

This sway bar kit utilizes a lined in the sway bar bushing. The lined allows the sway bar to move freely and quietly in the bushing. No lubrication is required.

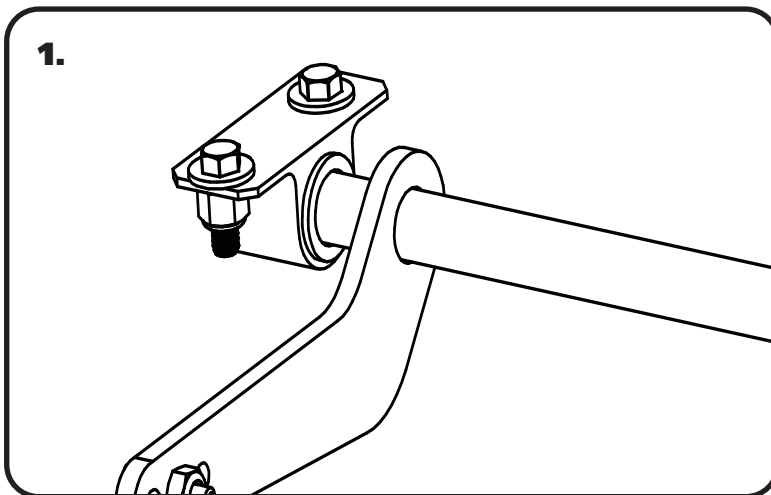

1. Install the swaybar bushings and straps onto the MuscleBar. The bushings and straps get installed on the outer ends of the MuscleBar against the stop rings.



Note: This picture illustrates where the MuscleBar is positioned on the frame for drilling the holes. The Swaybar is located in front of the "C"-Notches against the bed support. The arms on the MuscleBar drop down and point to the rear of the truck. On 67-72 Trucks the bed support will aid you in positioning the mounts. On 63-66 the rear tab of the swab bar mount is 5 1/2" from the front of the "C"-Notch (Diagram #2).



MuscleBar Installation

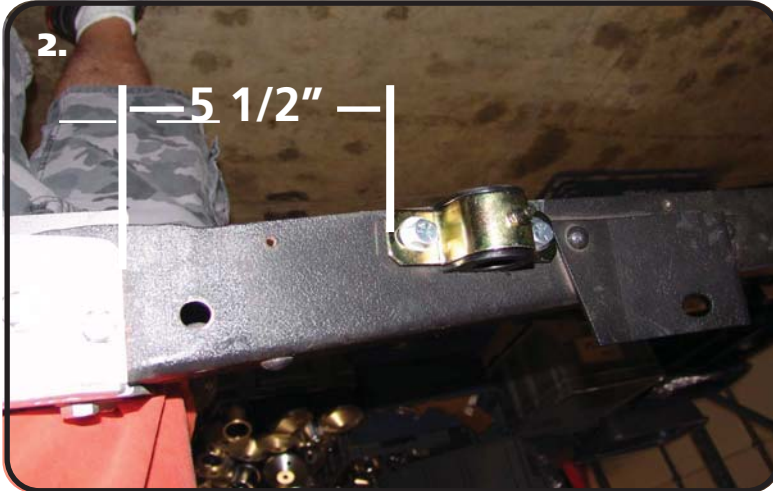

2. On 67-72 Trucks position the Musclebar so that the strap touches the rear corner of the bed support on the frame. Center it side to side. You can double check yourself by measuring from the rear of the mount to the front of the "C"-Notch 5 1/2" (Figure #2). Drill 7/16" holes using the straps as a template. With the holes drilled position the swaybar on the **BOTTOM** side of the frame. Attach the bushing straps to the frame using (4) 7/16 x 1 1/4" bolts, (4) 7/16" Nylok nuts, and (8) 7/16" SAE Flatwasher. Install a flatwasher under the bolt head, and one under the Nylok nut. Do not tighten these bolts unit the Posilinks are hooked up in the next step.



3. Attach the Posilinks in the **CENTER** hole of the MuscleBar and the StrongArm using a 3/8" SAE Flatwasher on each side of the arm on the MuscleBar and each side of the bracket on the StrongArm. Install 10mm Nylok nut on each posilink and tighten down. Torque hardware to 37 ftlbs.

4. Torque the bolts attaching the bushings bracket to the frame to 50 ftlbs. After installation, be sure that the Musclebar will go through the entire suspension travel without contacting anything

The MuscleBar has 3 positions to aid in the tuning of your trucks handling. We start in the center position and tune from there. The Position to the front of the truck will make the Musclebar stiffer. The position to the rear of the truck will make the MuscleBar softer.