



**INSTALLATION
INSTRUCTIONS**



Part # 12109121



Front Sway Bar

1967-1970 Mustang/Cougar w/Big Block



www.ridetech.com
812.482.2932





**Please Read And Understand All Instructions
And Warnings Prior To The Installation Of
This Product.**

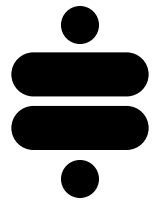

THANK YOU

Congratulations on your new Ridetech product! It's an honor that you've selected the Ridetech brand to upgrade your ride. Our products are developed around quality and performance without compromise. We're confident you'll have many years (and miles) of pure driving enjoyment.
Thank you for choosing Ridetech!

Road Map

Sway Bar Installation

3-4

**NOTE: The bushings in this kit contain an anti-friction lining.
No lubrication is required.**

COMPONENTS		
Part Number	Description	Qty
70015013	Sway Bar Bushing	2
90001344	Billet Sway Bar Mount	2
90002611	Sway Bar	1
90002929	End Link Kit	2
99372002	3/8"-16 Nylok Nut	4
99373020	3/8" Flat Washer	4

Sway Bar Installation

1. Raise the vehicle to a safe and comfortable working height.
2. Remove the existing sway bar.
3. Spread open each bushing and install onto the bar (Figure 1).

4. Position the bushings at the approximate locations circled in Figure 2.

5. Slide a billet strap over each bushing (Figure 3).



Figure 1

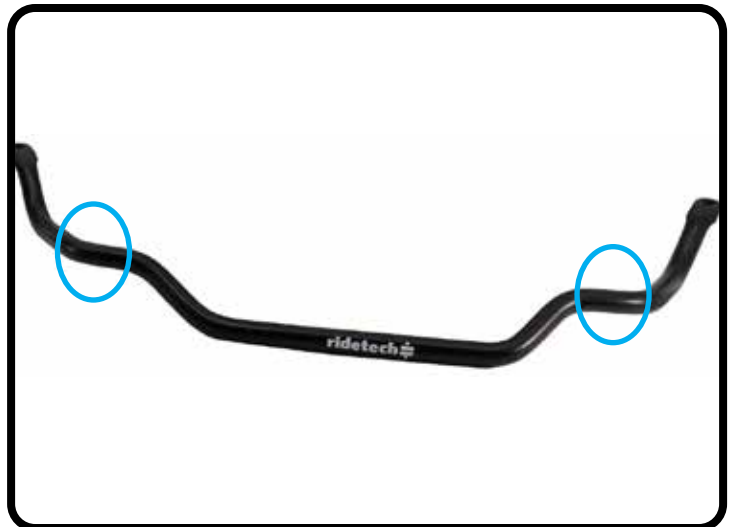

Figure 2



Figure 3

Sway Bar Installation

6. Position the new sway bar at the original location on the car (Figure 4).

7. Secure the bar to the frame using the existing studs along with the supplied 3/8" washers and Nylok nuts (Figure 5).

Torque the 3/8" nuts to **35 ft-lbs**.

8. Install the end links. Refer to the exploded view in Figure 6 for reference.

Install both end links before tightening the end links.

Tighten the end link barrel nut until it is flush with the end of the bolt, and then tighten it 2 more complete turns.



Figure 4



Figure 5

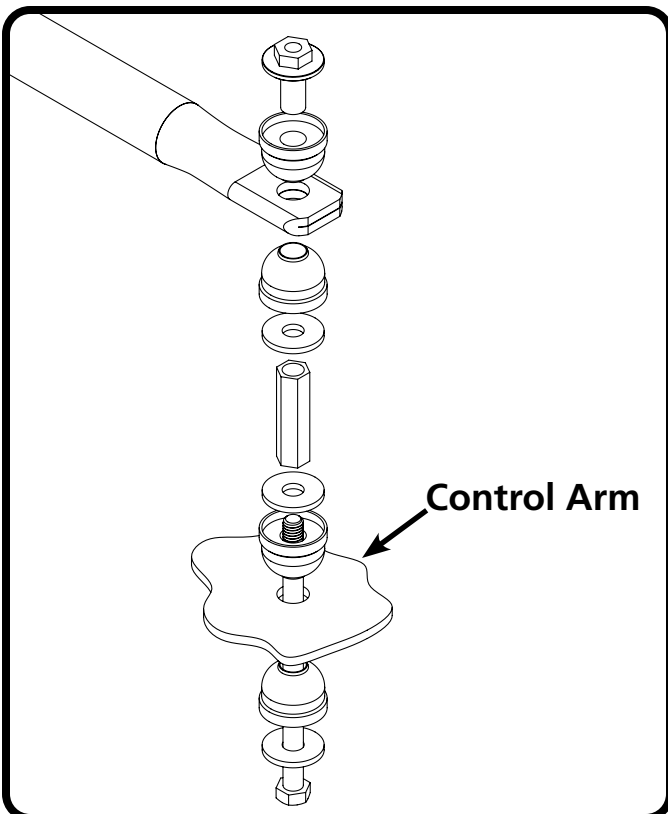

Figure 6