

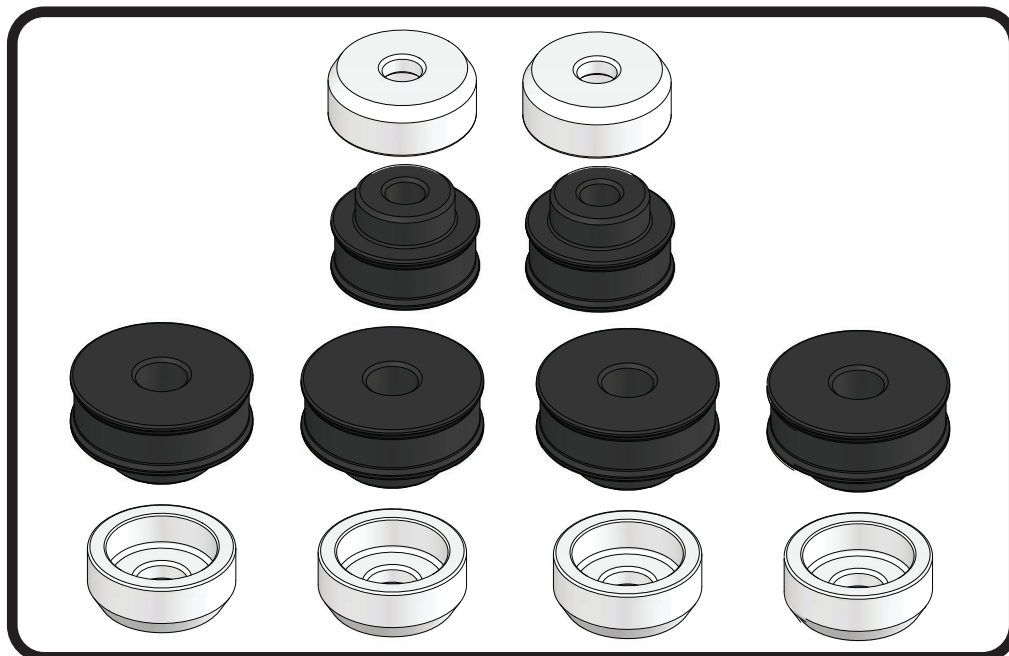

### Part # 81001000

1967-1981 GM "F" Body, 1968-1974 GM "X" Body Subframe Bushings



#### Recommended Tools

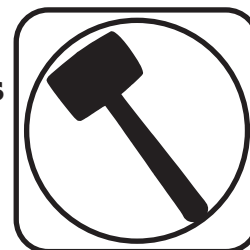
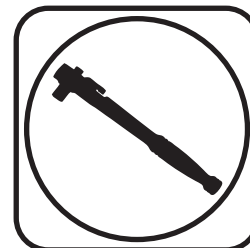

67-81 GM "F" Body, 67-74 "X" Body Subframe Bushings

# Installation Instructions

### Table of contents

Page 2..... Included Components & Hardware List

Page 3..... Tips & Tricks for Installation

These bushings are designed to help eliminate flex between the body and subframe. Reducing flex helps to improve the cars responsiveness. The bushing bases are made from delrin to help reduce NVH compared to aluminum bushings.





### Major Components .....In the box

Item #	Part #	Description	QTY
1	90003840	Front Bushing Cap	2
2	70014637	Front Bushing Base	2
3	70014638	Rear Bushing Base	4
4	90003841	Rear Bushing Cap	4
	99010184	Hardware Kit	1

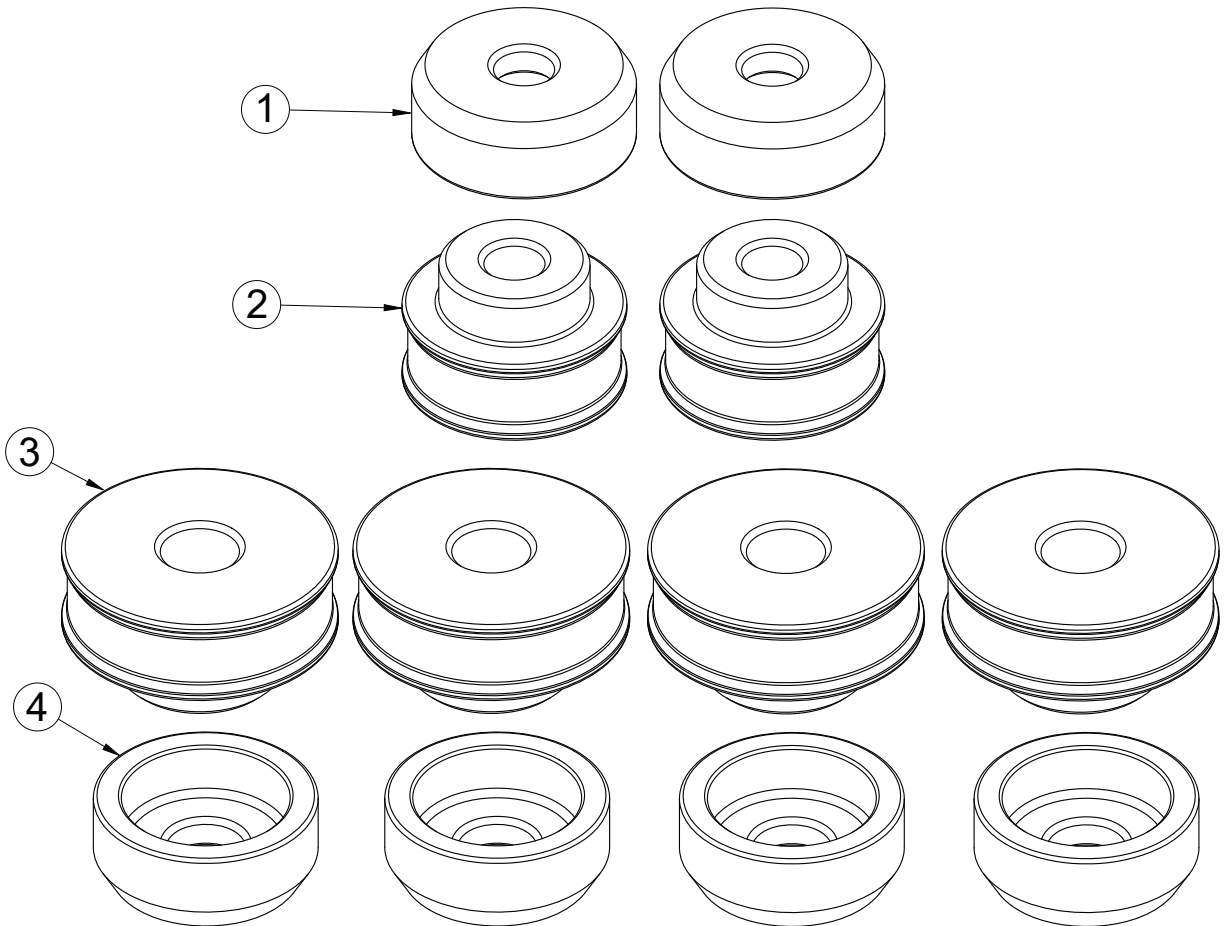

### Hardware List .....In the box (Kit# 99010184)

QTY	Part Number	Description	QTY	Part Number	Description
<b>Front Bushings</b>			<b>Rear Bushings</b>		
2	99501012	1/2"-20 x 3" Hex Bolt	4		5/8"-11 x 3 1/2" Hex Bolt
2	99502002	1/2"-20 Nylok Nut	4	99503001	5/8" SAE Flat Washer
4	99503014	1/2" SAE Flat Washer	4	99503002	5/8" Split Lock Washer



### Tips & Tricks for Installation

1. Spray all the hardware to be removed with your preferred penetrating lube.
2. Check fan to fan shroud clearance before trying to raise either side of the body. If there isn't much room, you may have to remove the shroud for the bushing installation.
3. When disassembling, mark the location and number of alignment shims that may have been used when the car was assembled. These shims will need to be reinstalled for proper body alignment.
4. When using on 68-74 Nova, you must reinstall the factory body mount spacers that are used at the firewall body mounts.
5. Use a long board on a jack to help prevent damage to the body when raising the body. Check to make sure there are no wires or lines in the way.
6. Only raise the body high enough to remove and reinstall the body bushings.
7. Loosen the hardware on both sides before jacking up one side of the body.
8. The Diagrams at the bottom of this page illustrate how these bushings will need to be installed. The core support bushings are setup to fit a 1/2" bolt. The body bushings are setup for a 5/8" bolt.
9. Leave the hardware loose until the body bushings have been installed in both sides.
10. Square the subframe using corner to corner measurements and wheel base measurements.
11. Check body to make the fenders and hood are properly aligned.
12. Torque the core support bushings to 30-40 ft-lbs. Torque the body bushings to 75-90 ft-lbs.

