

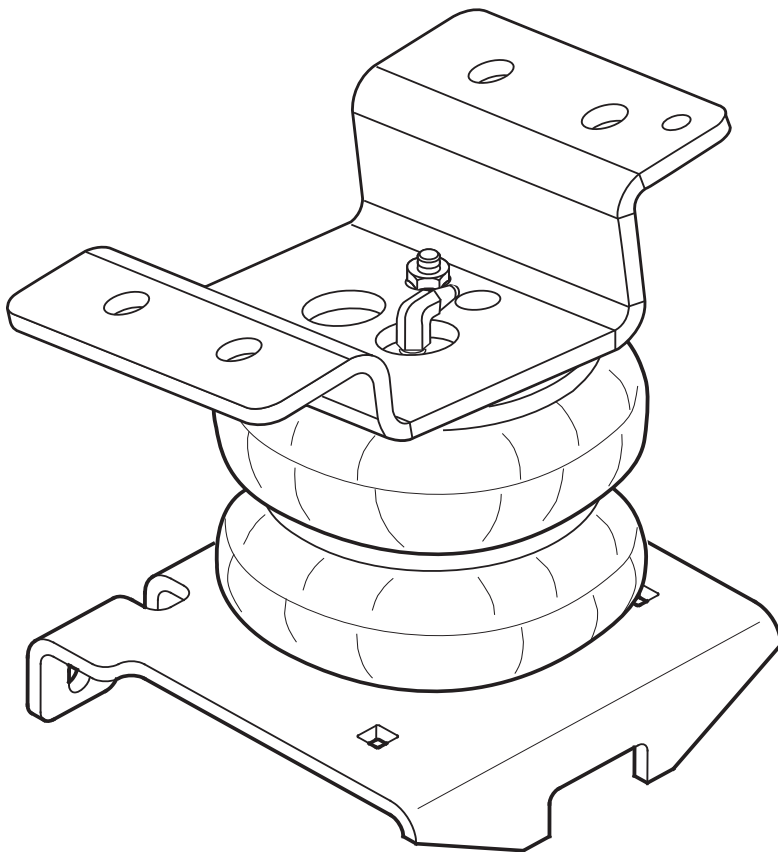

## 81213003 01-10 GM C2500-C3500-K2500-K3500

Congratulations - your new TowPro Helper Springs are quality products capable of improving the handling and comfort of your vehicle. As with all products, proper installation is the key to obtaining all of the benefits your kit is capable of delivering. Please take a few minutes to read through the instructions to identify the components and learn where and how they are used. It is a good idea to start by comparing the parts in your kit with the parts list below.



Components	Part#	QTY
AIR SPRING	6781	2
UPPER BRACKET	5766	2
LOWER BRACKET	5541	2
BRACKET CLAMP	0530	2
AIR LINE TUBING	0938	1
HEAT SHIELD	1004	1
BAIL CLAMP	3373	2

### Hardware

THERMAL SLEEVE	0899	2
3/8"-16 X 1-1/2" HEX BOLT		4
3/8"-16 FLANGE NUT		16
3/8"-16 X 3/4" FLANGE LOCK		2
3/8"-16 X 4" CARRIAGE BOLT		4
3/8"-16 X 3.5" CARRIAGE BOLT		1
3/8"-16 X 5/8" FLAT HEAD BOLT		2
3/8" FLAT WASHER		4

### WARNING!

Do not inflate this assembly when it is unrestricted. The assembly must be restricted by the suspension or other adequate structure. Do not inflate beyond 100 P.S.I. Improper use or over inflation may cause property damage or severe personal injury.

# KIT TO FRAME ASSEMBLY

Figure "A"

**NOTE:** Both illustrations are of the left, or drivers

## KIT ASSEMBLY

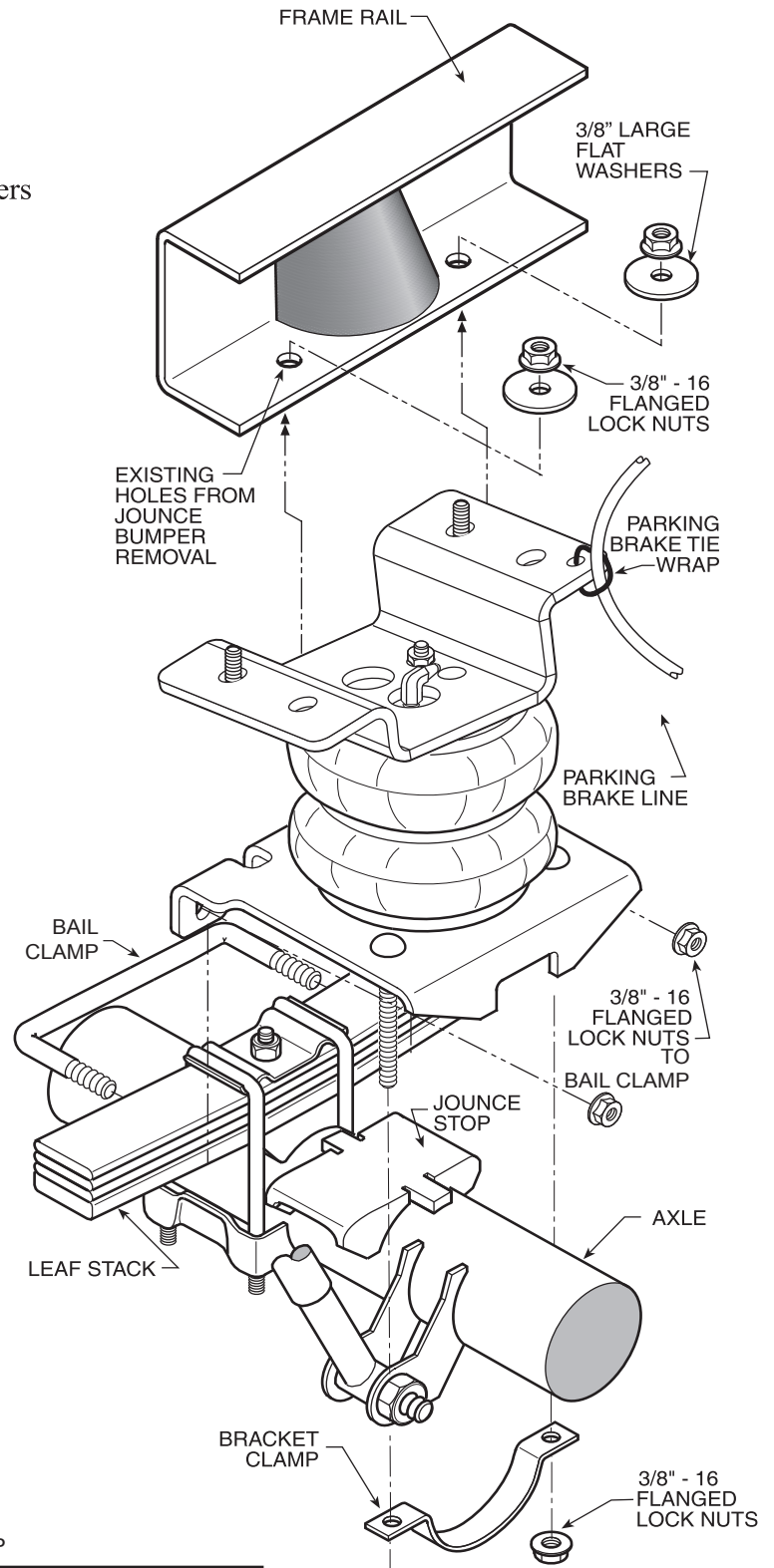
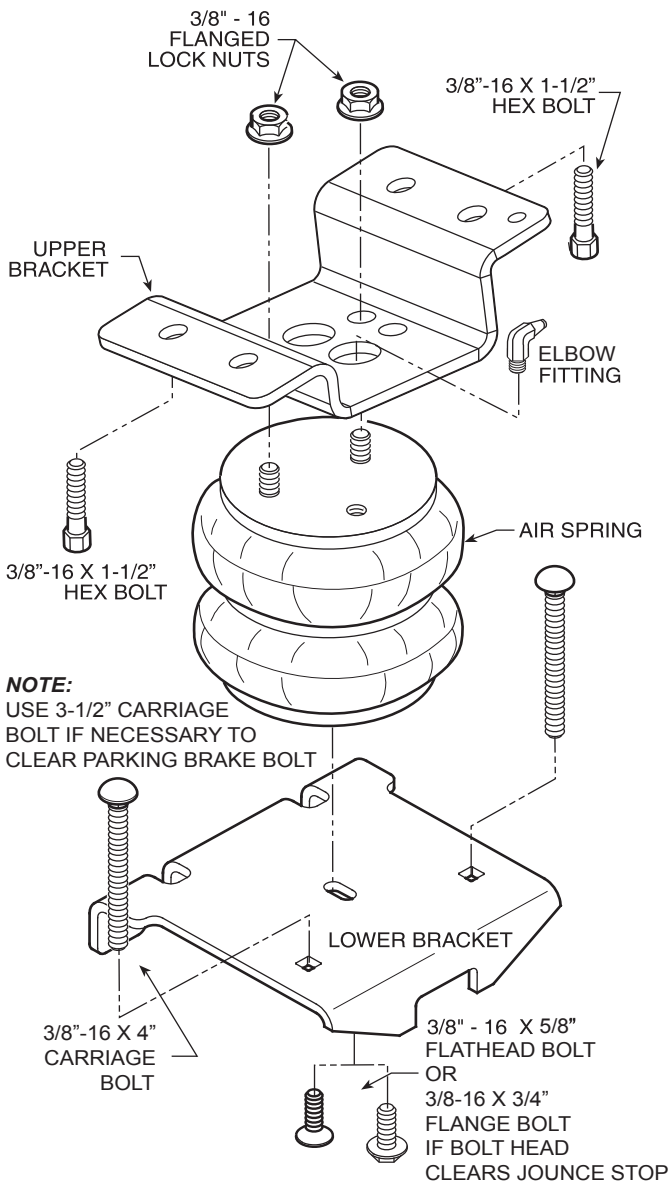



**LOWER BRACKET MUST BE PLACED BETWEEN U-BOLTS, SEE FIGURE "B"**

**NOTE:**

Please read through this manual completely before installing the air spring kit to your vehicle. A heat shield is required on the exhaust side of the vehicle as noted in Step 4. If your truck has an aftermarket dual exhaust system, you may have to order an extra heat shield.

**STEP 1 — PREPARE THE VEHICLE**

Remove the jounce bumper located under the frame rail, *see Figure "C"*. The jounce bumpers and nuts will not be reused with this kit. Remove the 13 mm bolt and brake line clip located on the shock bracket, *see Figure "D"*. Save the 13 mm bolt and brake line clip, they will be re-installed.

**STEP 2 — PRE-ASSEMBLE THE KIT**

Select one air helper spring from your kit. Install a 3/8"-16 x 1-1/2 bolt in the short side of the upper bracket marked "L", *see Figure "A"*. Install the upper bracket by inserting the air helper spring studs into the holes, use two 3/8"—16 lock nuts to secure the bracket to the air spring, *see Figure "A"*. Install the male fitting into the air spring through the large access hole in the upper bracket. Tighten the air fitting securely to engage the orange thread sealant. Place the carriage bolts into the square holes of the lower bracket and then fasten the lower bracket to the air helper spring using a 3/8"-16 x 5/8" flat head bolt or the 3/8"-16 x 3/4" flange bolt, if the bolt head clears the jounce stop. *See Figure "A"*.

**STEP 3 — INSTALLING THE ASSEMBLY TO THE VEHICLE**

Place the assembly on the top of the driver's side axle housing, *see Figures "A" & "B"*. Using the existing jounce bumper holes, install the upper bracket onto the frame with 3/8"-16 x 1-1/2 bolts, large flat washers, and 3/8"-16 flange nuts. The 3/8"-16 x 1-1/2" bolts will be facing upward with the washers and nuts on the inside of the frame rail, *see Figure "A"*. **On the drivers side only, the parking brake line will need to be tie-wrapped to the upper bracket, *see Figure "A"*.** Install the bail clamp under the leaf springs from the outside of the leaf stack into the holes in the legs of the lower bracket. Secure the bail clamp to the lower bracket with the 3/8"-16 flange nuts and draw the lower bracket against the leaf stack. *See Figures "A" & "B"*. Attach the lower bracket to the axle using the bracket clamp and the 3/8"-16 flange nuts, *see Figure "A"*. Once the assembly is in place, you must have a minimum of 1/2" clearance around the air spring for proper operation, *see Figure "B"*. Making sure that the brake line does not rub on the lower bracket, reinstall the brake line clip and bolt, *see Figure "D"*.

**STEP 4 — INSTALLATION OF THE PASSENGER'S SIDE ASSEMBLY**

**Note: The use of a heat shield is required on the passenger's side of the vehicle, *see Figure "E"*.** The heat shield will mount between the upper bracket and the air helper spring. Bend the heat shield so it will fall halfway between the air helper spring and the closest point on the exhaust. Be sure that the heat shield will not contact any other component as the suspension compresses (*i.e.* brake lines, shock absorbers, lower bracket assembly). Follow Steps 1-3 for assembly and installation of the passenger's side.

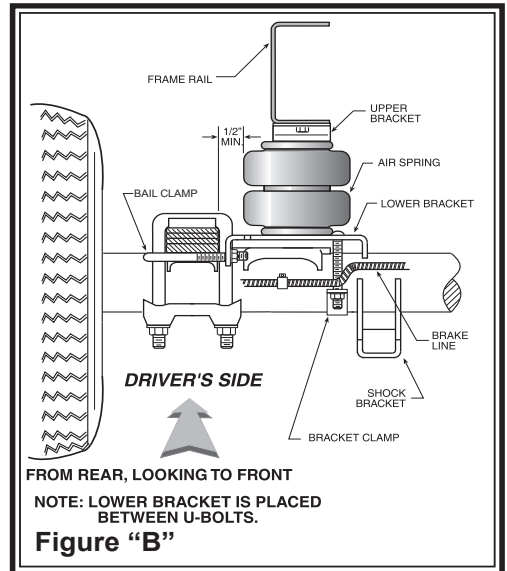

**Figure "B"**

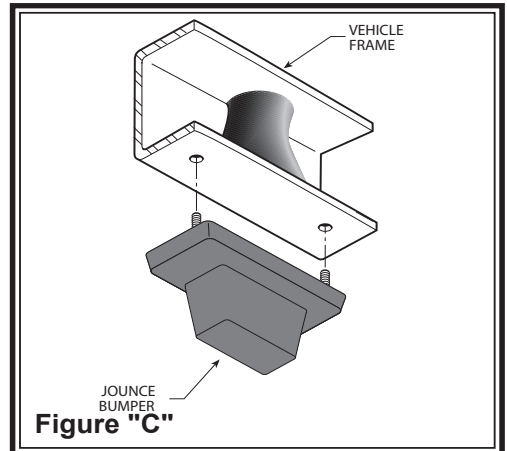

**Figure "C"**

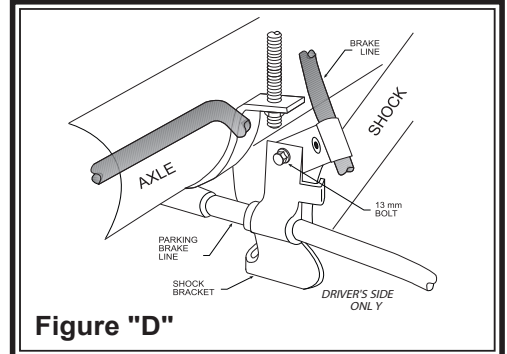

**Figure "D"**

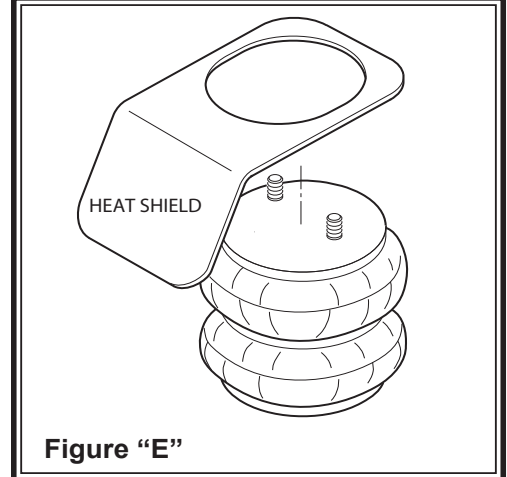

**Figure "E"**



**STILL HAVE QUESTIONS?**

**Tech line hours**

Monday - Friday  
8Am - 6PM (EST) ..... 812-482-2932