

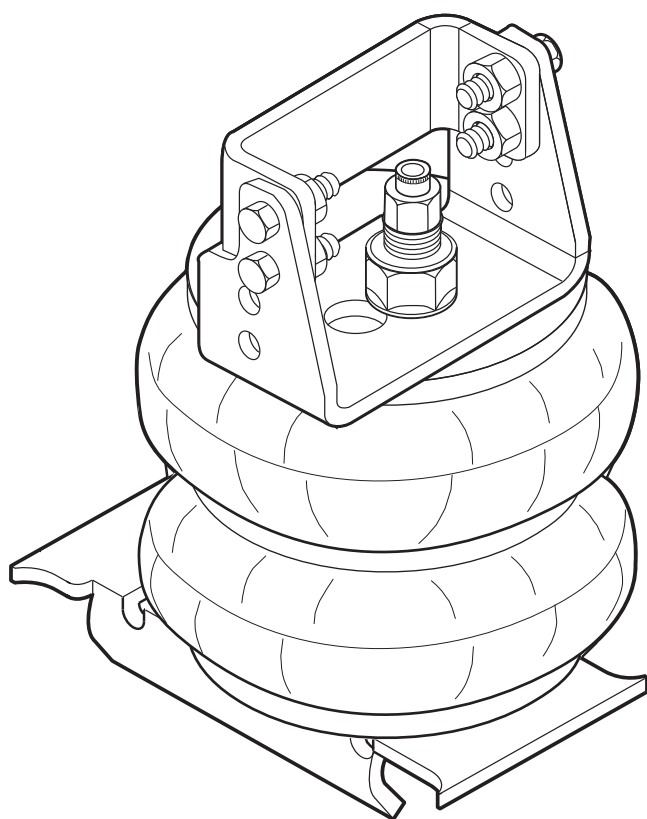

**81233004 06-08 1500 MegaCab 4WD, 03-13 Ram 2500  
03-12 Ram 3500**

Congratulations - your new TowPro Helper Springs are quality products capable of improving the handling and comfort of your vehicle. As with all products, proper installation is the key to obtaining all of the benefits your kit is capable of delivering. Please take a few minutes to read through the instructions to identify the components and learn where and how they are used. It is a good idea to start by comparing the parts in your kit with the parts list below.



**Components**

DESCRIPTION	PART#	QTY.
AIR SPRING	6401	2
UPPER BRACKET	5757	2
LOWER BRACKET BRACE	5758	2
LOWER BRACKET	5370	2
SPACER	5336	2
22 ft. TUBING		1
MALE FITTING	4000	2
THERMAL SLEEVE	0899	2
AXLE CLAMP BRACKET	5181	2
HEAT SHIELD	1004	1
3/8" -16 BAIL CLAMP	3292	2

**Hardware**

DESCRIPTION	QTY.
5/16" FLAT WASHER	4
10MM X 30MM FLAT HEAD BOLT	4
3/8" -16 X 3/4" FLANGED HEX BOLT	2
3/8" -16 X 1" HEX BOLT	8
3/8" -16 X 2" FLANGE BOLT	2
3/8" -16 FLANGE NUT	12
3/4" -16 HEX NUT	2
3/4" STAR WASHER	2
NYLON TIE WRAP	6

**WARNING!**

Do not inflate this assembly when it is unrestricted. The assembly must be restricted by the suspension or other adequate structure. Do not inflate beyond 100 P.S.I. Improper use or over inflation may cause property damage or severe personal injury.

**FIGURE "A"**

**NOTE:** Both illustrations are of the left, or driver's side, of the vehicle. Reverse any orientations when assembling and installing the right, or passenger, side of the vehicle.

**NOTE:** 4WD SHOWN, USE SAME PROCEDURES ON 2WD.

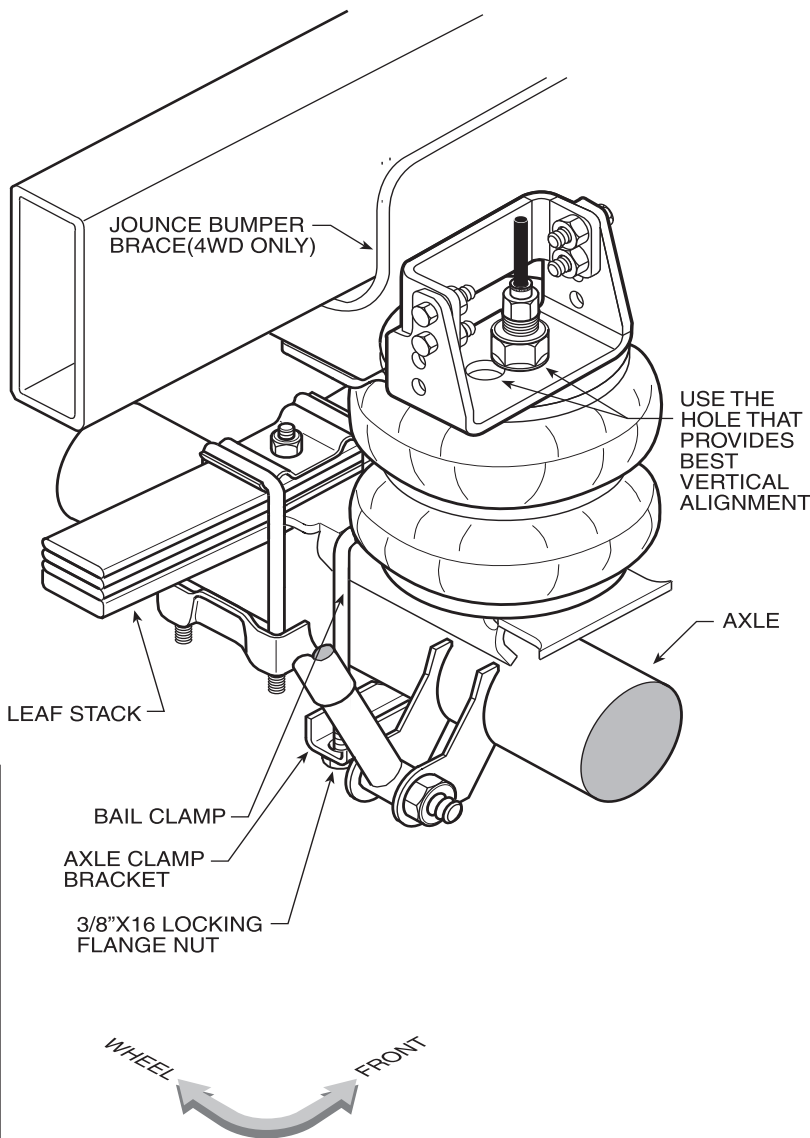

**KIT ASSEMBLY**

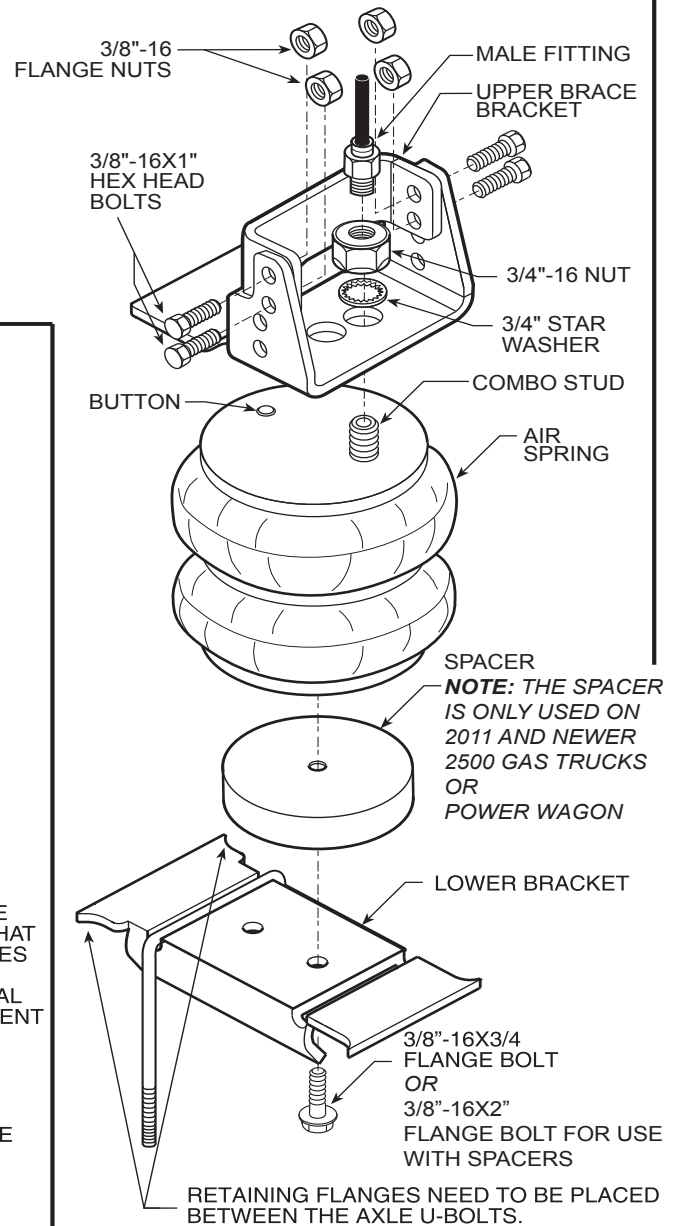

**Lower Bracket Orientation**

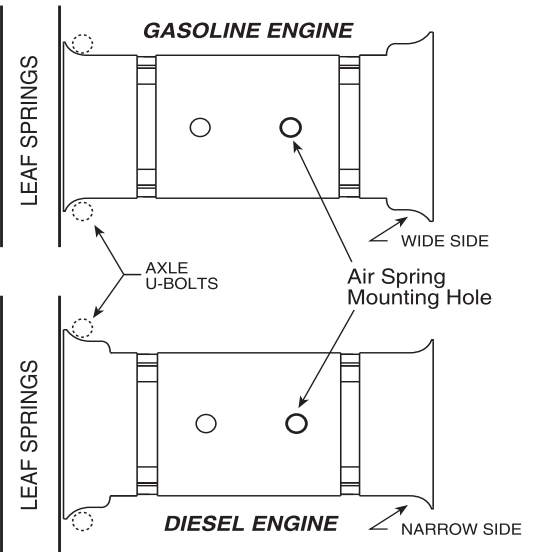

**NOTE:**

Please read through this manual completely before installing the air spring kit on your vehicle.

**STEP 1 — PREPARE THE VEHICLE**

With the vehicle on a solid, level surface chock the front wheels. Remove the negative battery cable. Your vehicle is equipped with rubber jounce bumpers. The jounce bumpers are bolted to the frame above the axle. Remove the jounce bumpers from the vehicle.

**STEP 2 — PRE-ASSEMBLE THE KIT**

Select a lower bracket from your kit and determine which side of the bracket fits most snugly between the axle U-bolts as shown in **Figure "A"**. **NOTE: The smaller side is for the gasoline engine axle and the larger side is for Diesel engine axle.** Select one air spring, bail clamp and lower bracket from your kit. Place the bail clamp in the correct position in the slot of the lower bracket for your vehicle. Install the air spring to the lower bracket using the hole for your vehicle with a 3/8"-16 x 3/4" flange head bolt that is mounted finger tight. **Please see the lower right section of Figure "A"**. The bolt will be tightened up in STEP 5. **NOTE: On 2011 and newer RAM 2500 gasoline engine and Power Wagons, a spacer will be need to be installed between the air spring and the lower bracket. If the spacer is used, use the 3/8"-16 x 2" flange head bolt.** Next, install the male air fitting into the air inlet in the combo stud of the air spring. Tighten the air fitting securely to engage the orange thread sealant.

**STEP 3A—INSTALLING THE UPPER BRACKET TO THE VEHICLE (TWO WHEEL DRIVE)**

Select an upper bracket and upper brace from your kit. Install the upper bracket to the frame using two 10 mm x 30 mm flat head bolts, see **Figure "A"**. Next, attach the brace using the lower set of holes that are marked "2WD" using four 3/8"-16 x 1" hex head bolts and four 3/8"-16 flange lock nuts, as shown in **Figure "B"**.

**STEP 3B—INSTALLING THE UPPER BRACKET TO THE VEHICLE (FOUR WHEEL DRIVE)**

Select an upper bracket and upper brace from your kit. Install the upper bracket to the frame using two 10 mm x 30 mm flat head bolts, see **Figure "A"**. Next, attach the brace using the upper set of holes that are marked "4WD" using four 3/8"-16 x 1" hex head bolts and four 3/8"-16 flange lock nuts, as shown in **Figure "B"**.

**STEP 4—INSTALLING THE ASSEMBLY TO THE VEHICLE**

Position the lower bracket and air spring assembly from STEP 2 on the axle as shown in **Figure "A"**. Put the large threaded stud through the large hole on the upper bracket and the locating pin of the air spring in the small hole on the upper bracket as shown in **Figure "A"**. **Make sure the alignment pin is in the locating hole before fastening air spring to the upper bracket.** Fasten the air spring to the upper bracket using 3/4"-16 hex head nut and 3/4" star washer. Fasten the lower bracket to the axle housing using the bail clamp and the axle clamp bracket and two 3/8"-16 locking flange nuts securely. Once the lower bracket orientation has been set, tighten the 3/8"-16 x 3/4" flange bolt that was installed in STEP 2.

**STEP 5—INSTALLATION OF THE PASSENGER'S SIDE ASSEMBLY**

Before following STEPS 1-4 with reverse orientations for assembly and installation of the passenger's assembly, a heat shield will need to be mounted between the upper bracket assembly and the top plate of the air spring, **see Figure "C"**. Position the heat shield directly between the closest heat source and the air spring. Ensure that the heat shield will not interfere with normal operation of the air spring or the vehicle's suspension. Do not position the heat shield directly above the axle, as it may contact the axle on full suspension travel.

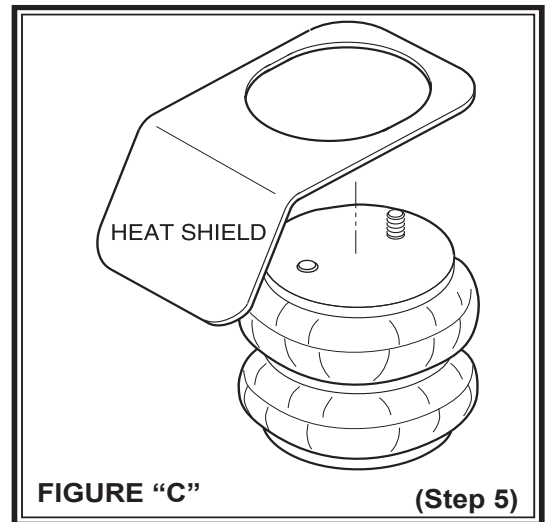
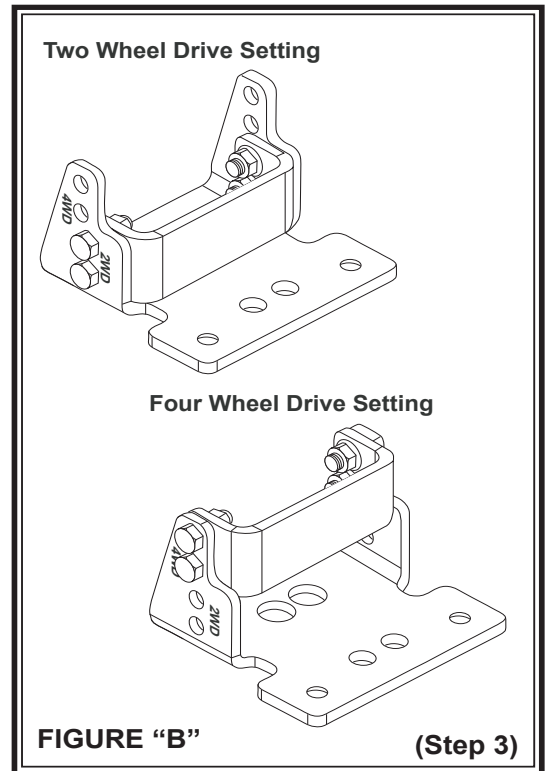

**Important: In order for the air spring to function properly, there must be a minimum of 1/2" of clearance around the air spring.**

This now completes the installation. Before proceeding, check once again to be sure you have proper clearance around the air springs. With a load on your vehicle and the air helper springs inflated, you must have at least 1/2" clearance around the air springs. As a general rule, the air helper springs will support approximately 50 lbs. of load for each psi of inflation pressure (per pair). For example, 50 psi of inflation pressure will support a load of 2500 lbs. per pair of air helper springs. FOR BEST RIDE use only enough air pressure in the air helper springs to level the vehicle when viewed from the side (front to rear). This amount will vary depending on the load, location of load, condition of existing suspension and personal preference.

**STILL HAVE QUESTIONS?**

**Tech line hours**

Monday - Friday 8Am - 6PM (EST) ..... 812-482-2932

